

# Maxi Controller

# PHC02

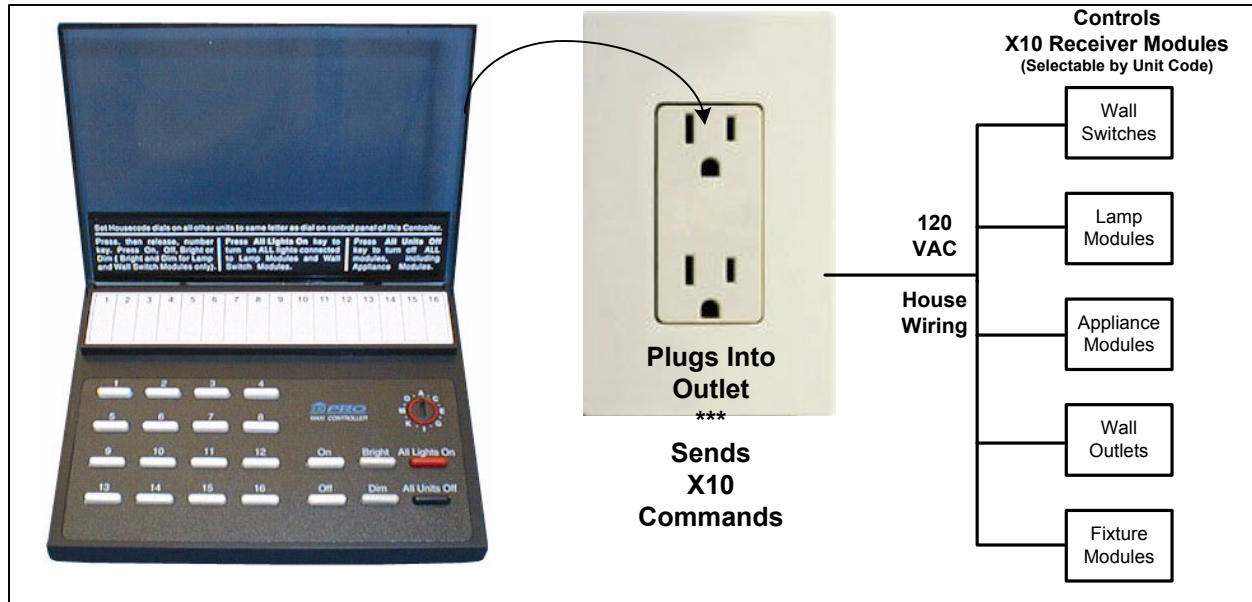

**Description:** The PHC02 Controls 16 X10 Receiver Modules of various formats. Just plug it in and you are in control! The PHC02 turns ON/OFF up to 16 lights and appliances connected to X10 Receiver Modules. The PHC02 has ON/OFF, Bright/Dim, All Lights On and All Units Off Command buttons.

**Specific Requirements:** 120VAC Power

#### Optional / Supplementary Devices & Modules:

PLM01 Plug-in Lamp Module, PLW01 Incandescent Wall Switch, PAM01 Plug-in Appliance Module, PAO11 Half-Split receptacle Module, XPFM Wire-in Fixture Module or any other X10 Receiver Modules.

#### X10 Protocol:

**House Code Dial** - Letters A-P    **Number Dial** - Numbers 1-16

Each X10 Receiver Module is set to a unique Unit Number or to an identical Unit Number as desired.

Each X10 Controller operating a specific set of Receiver Modules must be set to the same House Code as the Receivers they are controlling.

#### Electrical Protocol:

Nearly all residential homes are wired SPLIT-PHASE. Each 120V Phase is NOT directly connected with the other 120V phase. If after installation, an X10 Receiver does not respond to a remote Controller, then check to ensure that the breaker serving the X10 Receiver is on the same phase as the Controller. If not, the breaker can be changed to the opposite phase. An alternative solution is recommended, to install a Phase Coupler for improving remote communications throughout the home. See [www.x10pro.com](http://www.x10pro.com), then select Technical Support and PLC Troubleshooting.

#### Installation:

1. Install and set up all of your X10 Receiver Modules referring to the instructions included with them.
2. Set all of your X10 Receiver Modules to the same House Code as you set on the Mini Controller.
3. Set each X10 Receiver Module to a Unit Code between 1 and 16.

#### To turn ON or OFF a light or appliance

Press and release the Unit Number button corresponding to the Unit Code set on the X10 Receiver Module to be controlled. Then Press ON or OFF as desired. You can press as many Unit Numbers as desired, prior to pressing ON or OFF and the Controller will "Group Control" the Receivers.

#### To Dim or Bright lights

Press and release the Unit Number button for the X10 Receiver Module you wish to Dim or Brighten (you can't Dim or Brighten Appliance or Wall Outlet Modules). Then press ON. Press and Hold the Bright or Dim button, until the desired brightness level is reached.

#### To Turn All Lights On

Press the All Lights On or ALL Units Off button to instantly turn on ALL lights connected to Lamp Modules and Wall Switch Modules (which are set to the same House Code as the Mini Controller). This key does not affect Appliance or Wall Outlet X10 Receiver Modules.

#### To Turn All Units Off

Press the ALL Units Off button to instantly turn OFF ALL X10 Receiver Modules (which are set to the same House Code as the Maxi Controller). This includes Appliance or Wall Outlet X10 Receiver Modules.

The X10 PRO Maxi Controller will always turn lamps and appliances ON after you press the buttons. There can be some unexpected consequences. An empty coffee pot can be remotely turned ON. If that should happen, your coffee pot may be damaged from overheating. If an electric heater is turned ON while clothing is draped over it, a fire could result. Do not use X10 for the control of high power heating appliances or portable heaters.